

Dual-in-line sockets 2.54mm

Open frame
Solder tail



深圳平志电子有限公司
SHENZHEN PIZCONN ELECTRONIC CO.,LTD

TEL:86-755-84106483 61121902

FAX:86-755-61121902

E-mail:ivan@pizconn.com.cn

Ordering information

TPA11 - NNN X - B P P 1320A

No. of Positions	Row spacing code	Pin Plating code	Clip Plating code
	3 7.62mm	1 Tin150μ"	1 Tin150μ"
	4 10.16mm	2 Tin200μ"	2 Tin200μ"
	6 15.24mm	3 GF	3 GF
	9 22.86mm	4 Gold2μ"	4 Gold2μ"
		5 Gold3μ"	5 Gold3μ"
		6 Gold10μ"	6 Gold10μ"
		7 Gold15μ"	7 Gold15μ"
		S Special	S Special

Series: TPA11

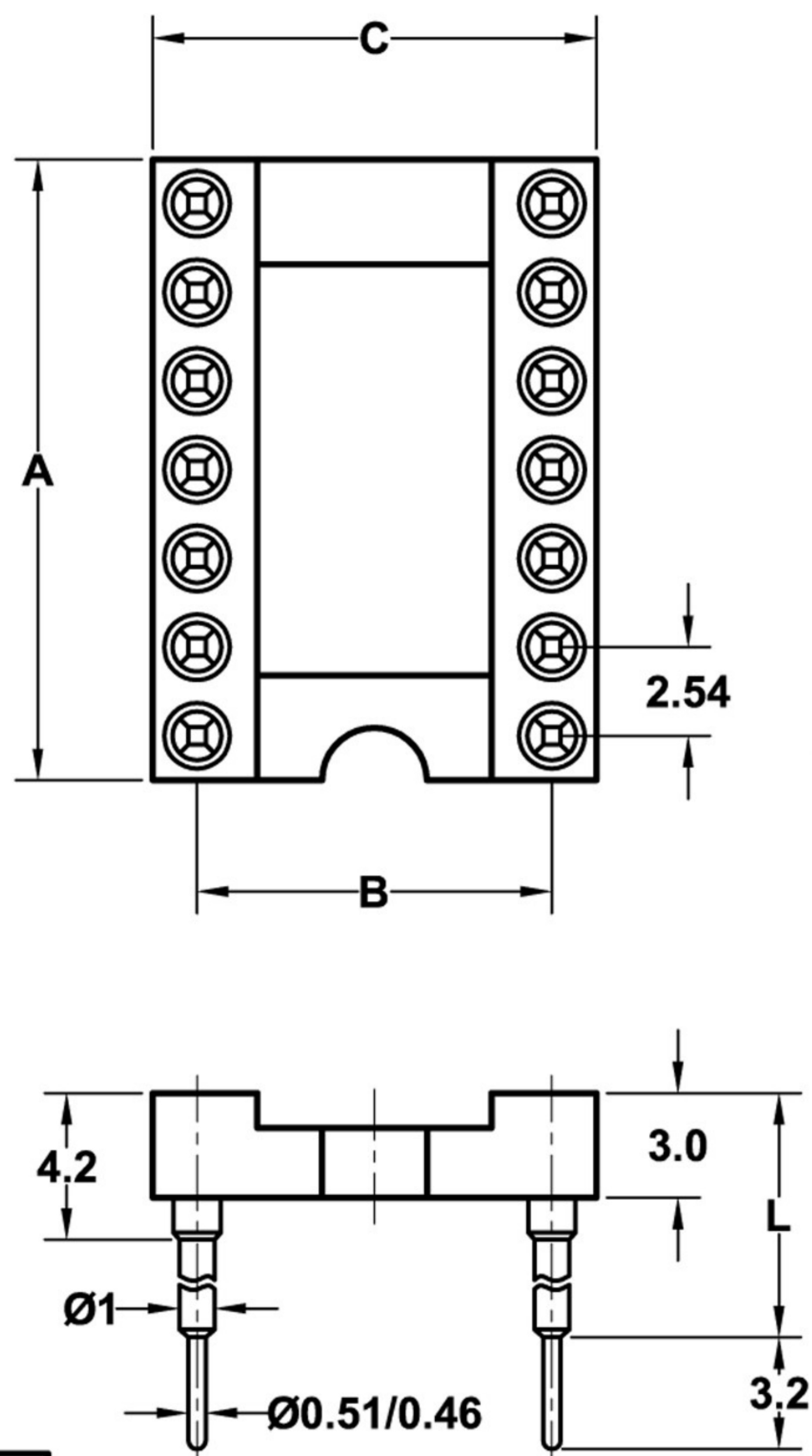
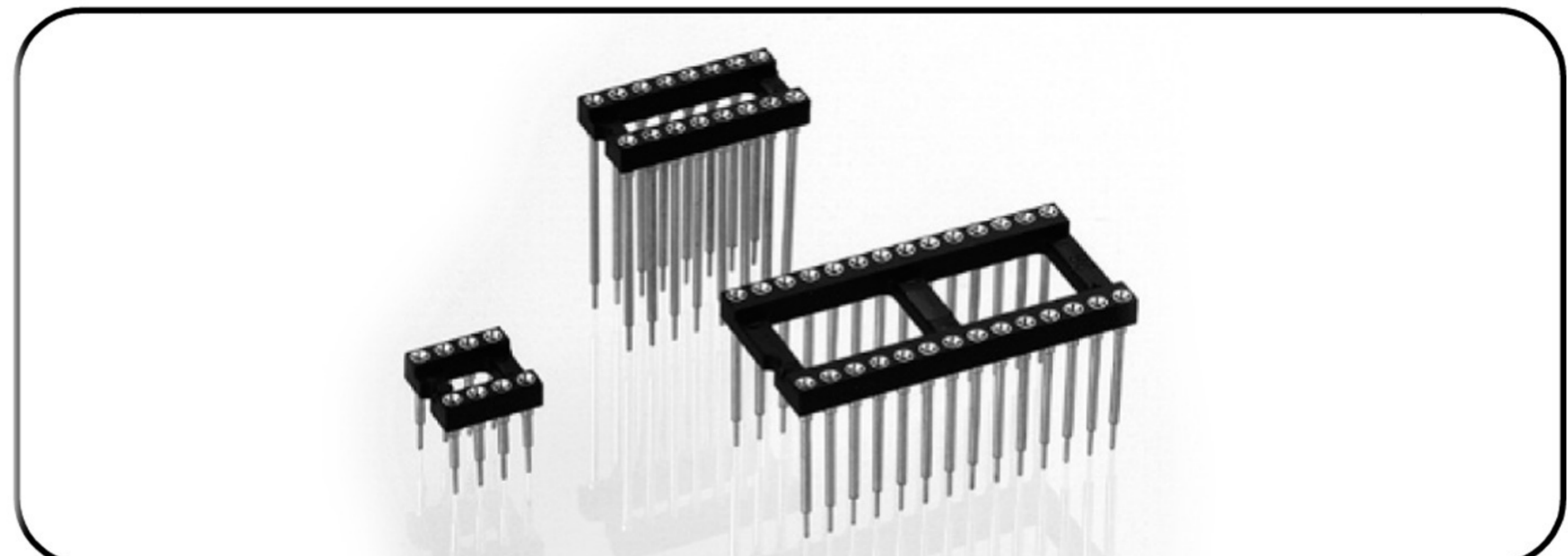

Open frame standard low profile DIL Sockets

Technical Specs:

Insulator:	Black glass filled polyester PBT-GF30-FR
Flammability:	UL 94V-O
Sleeve:	Brass CuZn 36pb3(36000)
Contact clip (4 finger):	Beryllium copper (C17200)
Mating pin Ø:	0.40 to 0.56 mm
Forces:	(polished steel gauge Ø 0.43mm)
-Insertion	2 N typ.
-Withdrawal	1 N typ.
Mechanical life:	min 100 cycles
Rated current:	1 A
Contact resistance:	max 10 mΩ
Dielectric strength:	min 1000V _{RMS}

code XXXX	Contact length L
0920	6mm
1020	7mm
1120	8mm
1220	9mm
1320	10mm
1420	11mm
1520	12mm
1620	13mm
1820	15mm
2120	18mm
2520	22mm
3620	33mm

fig.	No. of Positions	A	B	C	Order Codes
fig. 17	24	30.5	15.24	17.7	TPA11-0246-BPPXXXXA
fig. 18	28	35.5	15.24	17.7	TPA11-0286-BPPXXXXA
fig. 19	32	40.6	15.24	17.7	TPA11-0326-BPPXXXXA
fig. 20	36	45.7	15.24	17.7	TPA11-0366-BPPXXXXA
fig. 21	40	50.8	15.24	17.7	TPA11-0406-BPPXXXXA
fig. 22	42	53.3	15.24	17.7	TPA11-0426-BPPXXXXA
fig. 23	48	60.9	15.24	17.7	TPA11-0486-BPPXXXXA
fig. 24	50	63.5	15.24	17.7	TPA11-0506-BPPXXXXA
fig. 25	52	66.0	15.24	17.7	TPA11-0526-BPPXXXXA
fig. 26	50	63.5	22.86	25.3	TPA11-0509-BPPXXXXA
fig. 27	52	66.0	22.86	25.3	TPA11-0529-BPPXXXXA
fig. 28	64	81.2	22.86	25.3	TPA11-0649-BPPXXXXA

See page 37	No. of Positions	A	B	C	Order Codes
fig. 1	6	7.6	7.62	10.1	TPA11-0063-BPPXXXXA
fig. 2	8	10.1	7.62	10.1	TPA11-0083-BPPXXXXA
fig. 3	10	12.6	7.62	10.1	TPA11-0103-BPPXXXXA
fig. 4	12	15.2	7.62	10.1	TPA11-0123-BPPXXXXA
fig. 5	14	17.7	7.62	10.1	TPA11-0143-BPPXXXXA
fig. 6	16	20.3	7.62	10.1	TPA11-0163-BPPXXXXA
fig. 7	18	22.8	7.62	10.1	TPA11-0183-BPPXXXXA
fig. 8	20	25.3	7.62	10.1	TPA11-0203-BPPXXXXA
fig. 9	22	27.8	7.62	10.1	TPA11-0223-BPPXXXXA
fig. 10	24	30.4	7.62	10.1	TPA11-0243-BPPXXXXA
fig. 11	28	35.5	7.62	10.1	TPA11-0283-BPPXXXXA
fig. 12	20	25.4	10.16	12.6	TPA11-0204-BPPXXXXA
fig. 13	22	27.8	10.16	12.6	TPA11-0224-BPPXXXXA
fig. 14	24	30.4	10.16	12.6	TPA11-0244-BPPXXXXA
fig. 15	28	35.5	10.16	12.6	TPA11-0284-BPPXXXXA
fig. 16	32	40.6	10.16	12.6	TPA11-0324-BPPXXXXA