

Dual-in-line sockets 2.54mm

Open frame
Surface mount



深圳平志电子有限公司
SHENZHEN PIZCONN ELECTRONIC CO.,LTD

TEL:86-755-84106483 61121902
FAX:86-755-61121902
E-mail:ivan@pizconn.com.cn

Ordering information

TPB3 - NNN X - B P P 0970A / B

No. of Positions	Row spacing code	Pin Plating code	Clip Plating code
	3 7.62mm	1 Tin150μ"	1 Tin150μ"
	6 15.24mm	2 Tin200μ"	2 Tin200μ"
		3 GF	3 GF
		4 Gold2μ"	4 Gold2μ"
		5 Gold3μ"	5 Gold3μ"
		6 Gold10μ"	6 Gold10μ"
		7 Gold15μ"	7 Gold15μ"
		S Special	S Special

Series: TPB3



Specially designed for reflow soldering including vapor phase. Gull wing terminations for maximum strength and easy in-circuit test

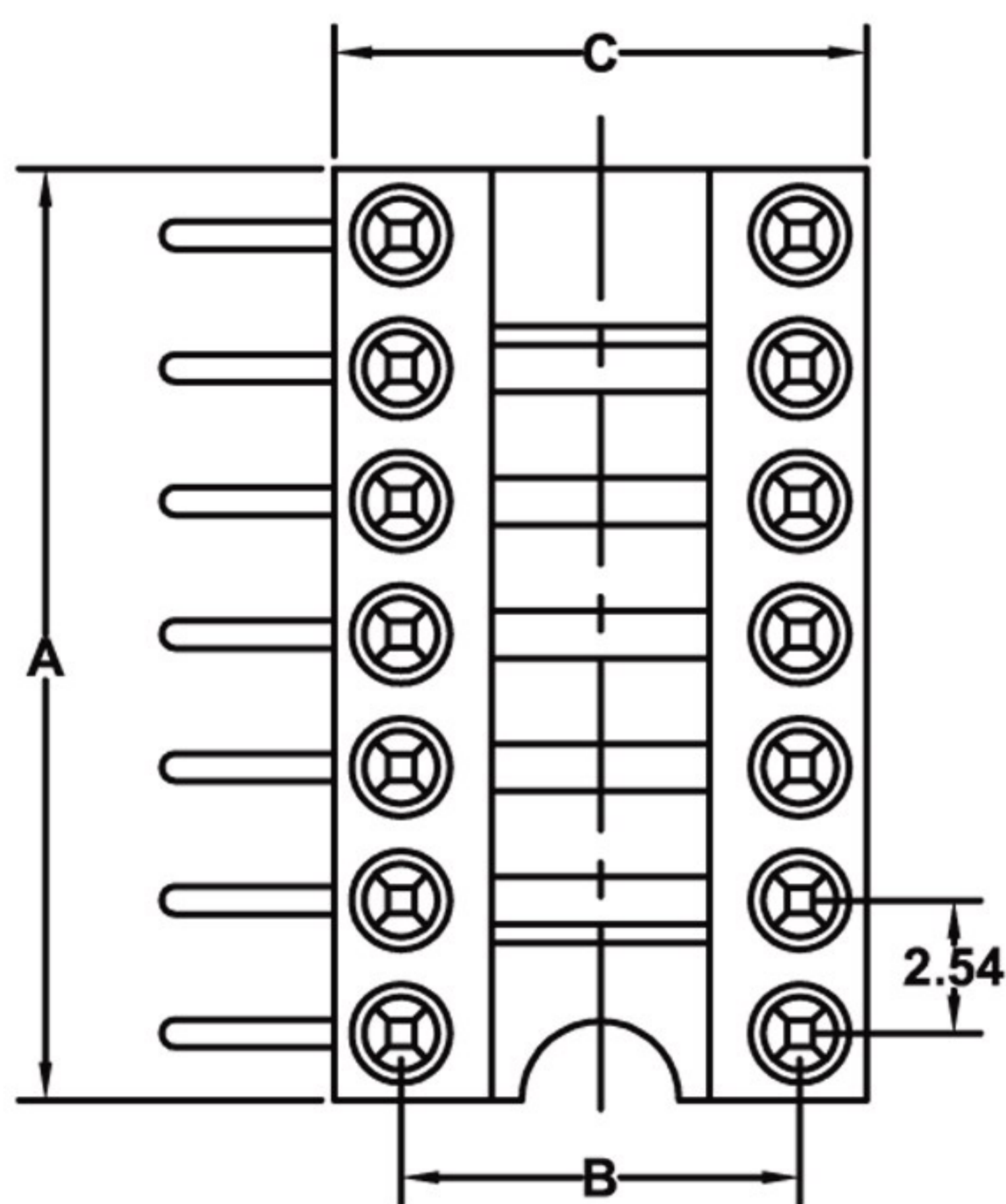

Insulator:	Black glass filled polyester PPS-GF30-FR
Flammability:	UL 94V-O
Sleeve:	Brass CuZn 36Pb3(36000)
Contact clip (4 finger):	Beryllium copper (C17200)
Mating pin Ø:	0.40 to 0.56 mm
Forces:	(polished steel gauge Ø 0.43mm)
-Insertion	2 N typ.
-Withdrawal	1 N typ.
Mechanical life:	min 100 cycles
Rated current:	1 A
Contact resistance:	max 10 mΩ
Dielectric strength:	min 1000V _{RMS}
terminations:	max 0.1mm

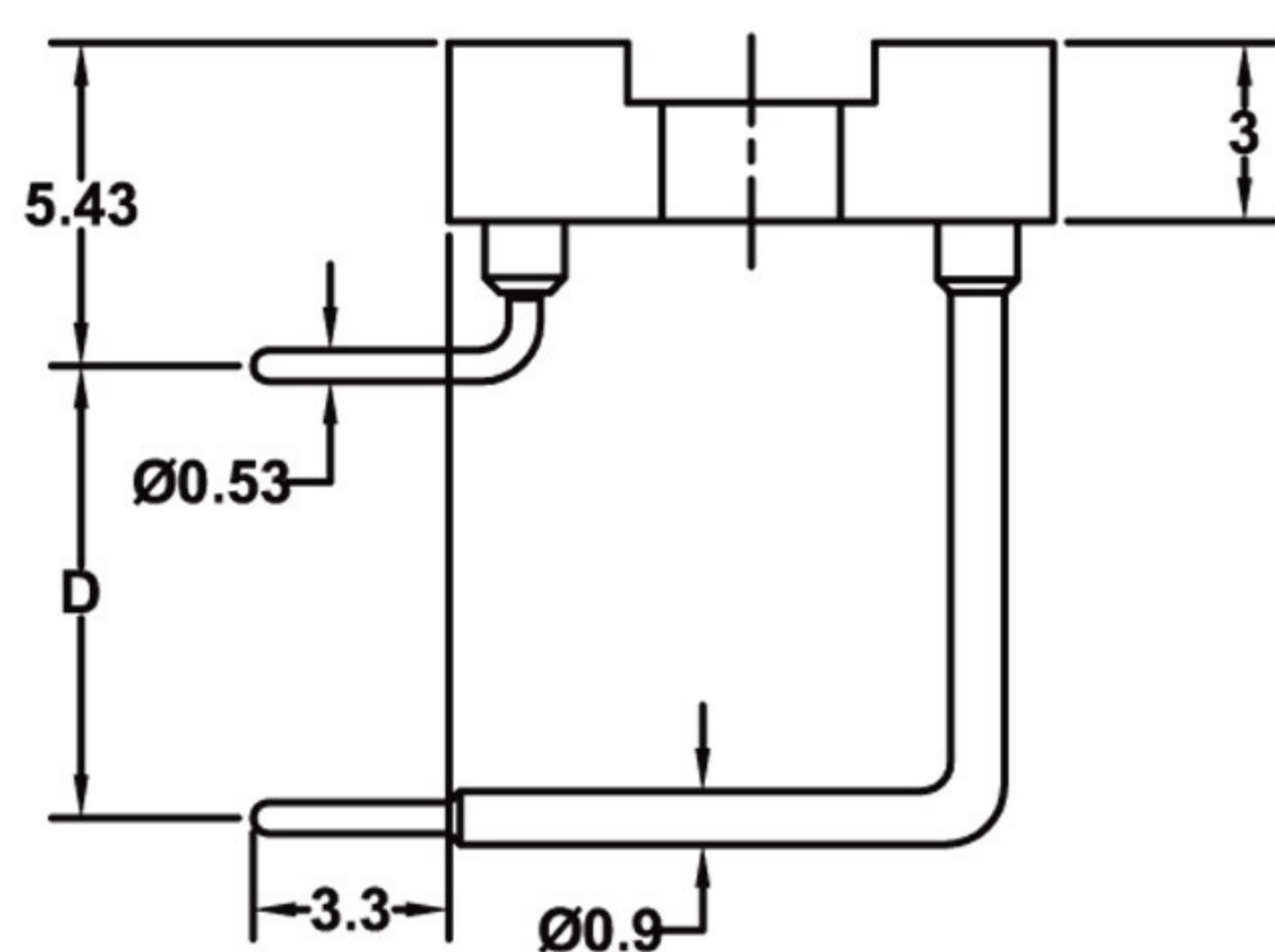

See page 100	No. of Positions	A	B	C	D	Order Codes
fig. 1	6	7.6	7.62	10.1	2.54 / 7.62	TPB3-0063-BPP0970A/B
fig. 2	8	10.1	7.62	10.1	2.54 / 7.62	TPB3-0083-BPP0970A/B
fig. 3	10	12.6	7.62	10.1	2.54 / 7.62	TPB3-0103-BPP0970A/B
fig. 4	12	15.2	7.62	10.1	2.54 / 7.62	TPB3-0123-BPP0970A/B
fig. 5	14	17.7	7.62	10.1	2.54 / 7.62	TPB3-0143-BPP0970A/B
fig. 6	16	20.3	7.62	10.1	2.54 / 7.62	TPB3-0163-BPP0970A/B
fig. 7	18	22.8	7.62	10.1	2.54 / 7.62	TPB3-0183-BPP0970A/B
fig. 8	20	25.3	7.62	10.1	2.54 / 7.62	TPB3-0203-BPP0970A/B
fig. 9	22	27.8	7.62	10.1	2.54 / 7.62	TPB3-0223-BPP0970A/B
fig. 10	24	30.4	7.62	10.1	2.54 / 7.62	TPB3-0243-BPP0970A/B
fig. 11	28	35.5	7.62	10.1	2.54 / 7.62	TPB3-0263-BPP0970A/B

fig. 12	24	30.5	15.24	17.7	2.54 / 7.62	TPB3-0246-BPP0970A/B
fig. 13	28	35.5	15.24	17.7	2.54 / 7.62	TPB3-0286-BPP0970A/B
fig. 14	32	40.6	15.24	17.7	2.54 / 7.62	TPB3-0326-BPP0970A/B
fig. 15	36	45.7	15.24	17.7	2.54 / 7.62	TPB3-0366-BPP0970A/B
fig. 16	40	50.8	15.24	17.7	2.54 / 7.62	TPB3-0406-BPP0970A/B
fig. 17	42	53.3	15.24	17.7	2.54 / 7.62	TPB3-0426-BPP0970A/B
fig. 18	48	60.9	15.24	17.7	2.54 / 7.62	TPB3-0486-BPP0970A/B